

TOGGLER® Plastic Toggle Anchors

Easy, secure, vibration-proof anchoring for medium loads!

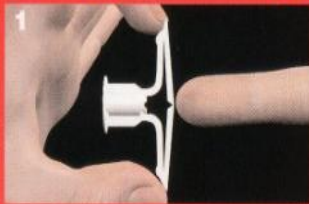

1 Drill 5/16" diameter hole (Ø8mm).
Fold anchor in middle.

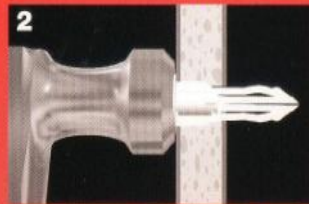

2 Insert anchor in hole and tap flush.
Only 3/4" (19mm) clearance
needed behind the wall. Only
1/2" (13mm) for the TA anchor.

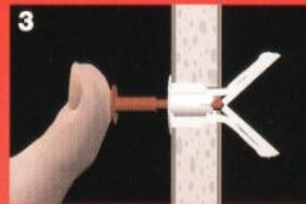

3 Insert key to pop anchor open
behind hollow wall (not necessary
for thick or solid walls).
Do *not* hammer key. Remove key.

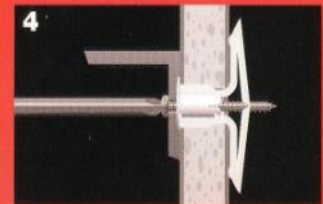

4 Place item over anchor. Insert
screw and tighten until flush
with item—then stop.

Benefits:

- **Strongest** of all plastic toggle anchors
- **Vibration & shock proof**—won't damage walls or ceiling
Used to install the sprinkler system in the Tokyo subway
- Can use a screw gun—anti-rotation fins **prevent spinning**
- **Greatest grip range** for each anchor:
 - TA 1/8"-1/4" TC 5/8"-3/4" T35 1 3/8" [35mm]
 - TB 3/8"-1/2" TD 1" [26mm] T39 1 1/2" [39mm]
- **Greatest screw range** for each anchor:
 - #6 through #14 TA = #8 through #12
 - [Ø3.5-6mm dia.] [Ø4-5.5mm dia.]
- All install in only a small 5/16" hole [Ø8mm]
- Pre-install **without the screw**
- Key-activated **positive locking system**
- Corrosion-proof, nonmagnetic, nonconductive

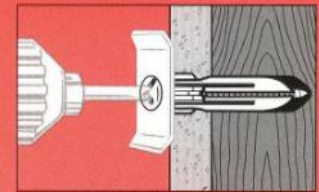

Each anchor holds securely, *even if* it hits an unexpected solid, like a stud or the door frame.



Ultimate Load in Pounds

Anchor:	TA®	TB®	TC®
Tensile			
Plywood	1/4" 124	1/2" 175	-
3/8" Drywall	-	97	-
1/2" Drywall	-	143	-
5/8" Drywall	-	102*	159
Shear			
Plywood	1/4" 265	-	-
3/8" Drywall	-	126	-
1/2" Drywall	126*	167	-
5/8" Drywall	-	214*	237
<i>Grip range:</i>	1/8"-1/4"	3/8"-1/2"	5/8"-3/4"
<i>Drill diameter:</i>	5/16"	5/16"	5/16"
<i>Screw tested:</i>	#8 x 1 1/4"	#8 x 1 1/2"	#8 x 1 3/4"

* Used as wedge anchors [not toggled fully open] in walls thicker than the anchor's grip range

For Medium Holding in:

- Drywall
- Gypsum board
- Plasterboard
- Greenboard
- Fiberglass
- Hollow-core doors
- Thin paneling
- Sheet metal
- Acoustic ceilings
- Masonite® panels

Ideal for Mounting:

- Towel bars
- Window treatments
- Bath accessories
- Kitchen accessories
- Smoke detectors
- CO detectors
- Electric boxes
- Lighting fixtures
- Mirrors on hollow-core doors
- Signs
- Alarms
- Clocks
- Shelving
- Telephones
- Thermostats
- Marine hardware
- Speaker mounts